

Twin impeller centrifugal pumps manufactured from stainless steel AISI 304, suitable for water supply, treatment & irrigation. Air conditioning systems and general water pumping including moderately aggressive liquids



### SPECIFICATIONS

- Maximum working pressure: 8 bar
- Maximum liquid temperature: 35°C according EN 60335-2-41 for domestic uses 60°C for other uses

### MATERIALS

- Pump body, impeller, diffuser, casing cover, bracket, shaft, motor casing and fan cover in AISI 304
- Mechanical seal in carbon/ceramic/NBR
- Special mechanical seal are available on demand

### TECHNICAL DATA

- T.E.F.C. 2 poles motor
- Insulation class F
- Protection degree IP55
- 1~230V ± 10% 50Hz, 3~230/400V ± 10% 50Hz
- Permanent split capacitor and automatic thermal overload protection for single-phase version
- Thermal protection to be provided by the user for three-phase version
- DNM 1" - DNA 1 1/4"

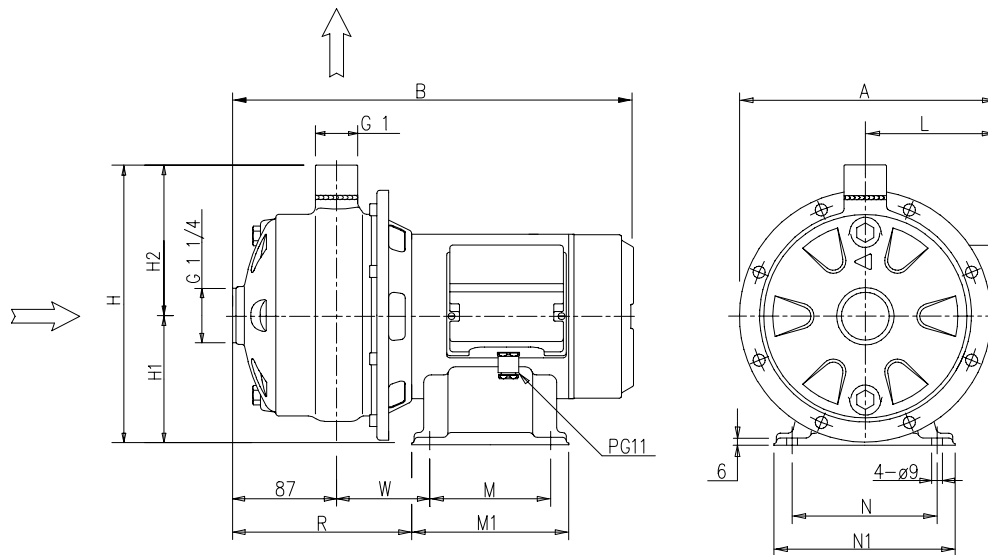

### DIMENSIONAL TABLE

| Pump type    |             | Dimensions (mm) |     |     |     |     |     |     |     |     |     |     |     |     |     | Weight |      |      |
|--------------|-------------|-----------------|-----|-----|-----|-----|-----|-----|-----|-----|-----|-----|-----|-----|-----|--------|------|------|
|              |             | A               |     | B   |     | H   | H1  | H2  | L   |     | M   | M1  | N   | N1  | R   | W      | kg   |      |
| Single-phase | Three-phase | 1~              | 3~  | 1~  | 3~  |     |     |     | 1~  | 3~  |     |     |     |     |     |        | 1~   | 3~   |
| 2CDM 70/10   | 2CD 70/10   | 210             | 206 | 363 | 363 | 229 | 106 | 123 | 106 | 102 | 100 | 130 | 120 | 150 | 164 | 93     | 14   | 14   |
| 2CDM 70/12   | 2CD 70/12   | 206             | 206 | 363 | 363 | 229 | 106 | 123 | 102 | 102 | 100 | 130 | 120 | 150 | 164 | 93     | 14,7 | 14,7 |
| 2CDM 70/15   | 2CD 70/15   | 226             | 226 | 375 | 393 | 229 | 106 | 123 | 110 | 110 | 120 | 150 | 140 | 170 | 170 | 95     | 17,8 | 17,8 |
| 2CDM 70/20   | 2CD 70/20   | 214             | 214 | 393 | 393 | 229 | 106 | 123 | 110 | 110 | 120 | 150 | 140 | 170 | 170 | 95     | 19,8 | 18,8 |
| 2CDM 120/15  | 2CD 120/15  | 214             | 214 | 375 | 393 | 229 | 106 | 123 | 110 | 110 | 120 | 150 | 140 | 170 | 170 | 95     | 16,1 | 15,8 |
| 2CDM 120/20  | 2CD 120/20  | 214             | 214 | 393 | 393 | 229 | 106 | 123 | 110 | 110 | 120 | 150 | 140 | 170 | 176 | 95     | 17,8 | 17,5 |

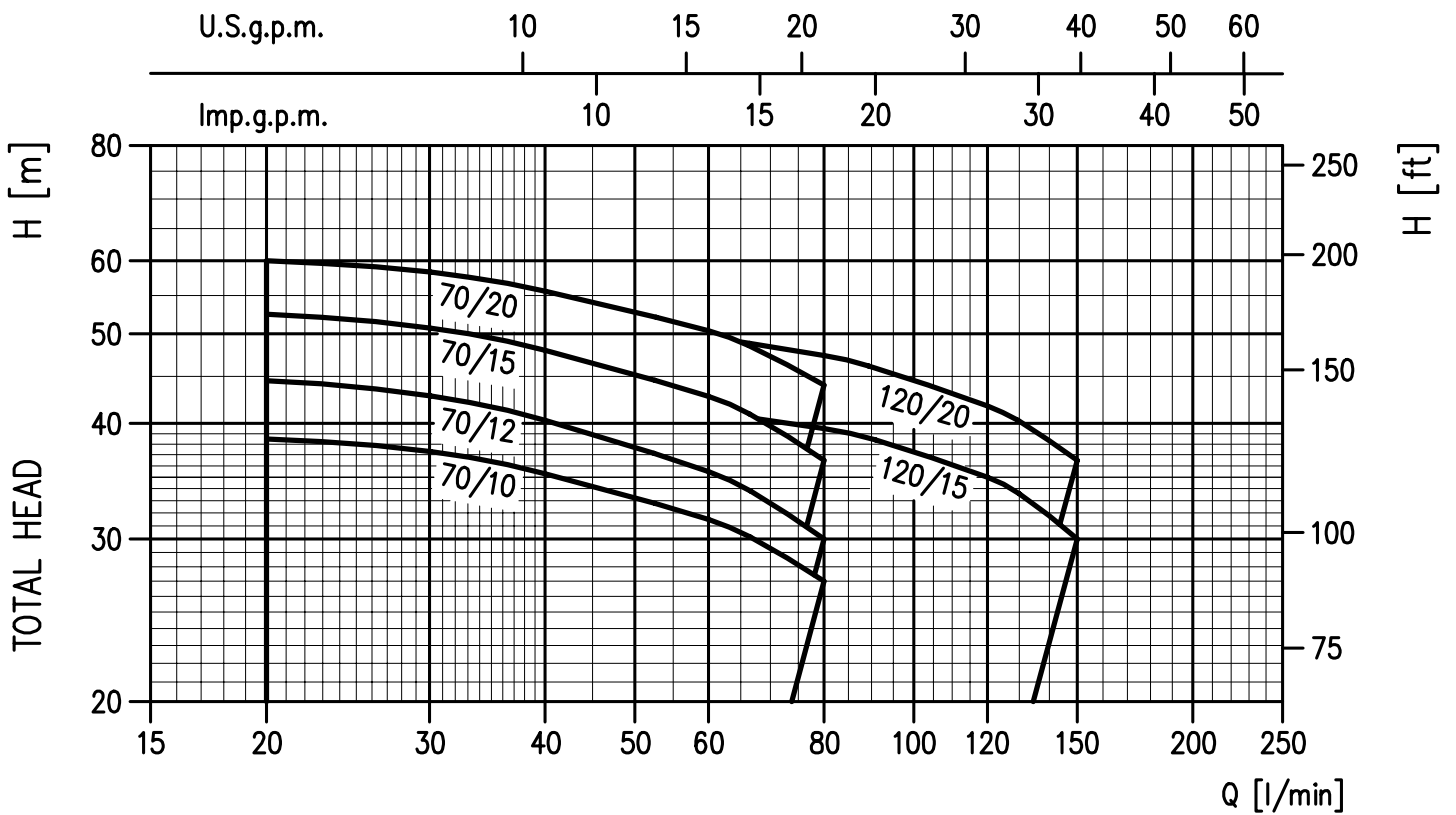
**PERFORMANCE CHART** (according to ISO 9906 grade 2)

**PERFORMANCE TABLE**

| Pump type                 |                              | kW   | Capacitor |                | Absorbed Current (A) |                          |     | l/min<br>m <sup>3</sup> /h | Q=Capacity |      |      |      |      |     |
|---------------------------|------------------------------|------|-----------|----------------|----------------------|--------------------------|-----|----------------------------|------------|------|------|------|------|-----|
| Single-phase<br>230V 50Hz | Three-phase<br>230/400V 50Hz |      | μF        | V <sub>c</sub> | Single-phase         | three-phase<br>230V 400V |     |                            | 20         | 40   | 60   | 80   | 120  | 150 |
| 2CDM 70/10                | 2CD 70/10                    | 0,75 | 20        | 450            | 5,8                  | 4,0                      | 2,3 | 1,2                        | 2,4        | 3,6  | 4,8  | 7,2  | 9    |     |
| 2CDM 70/12                | 2CD 70/12                    | 0,9  | 31,5      | 450            | 7,0                  | 5,0                      | 2,9 | 38,5                       | 35,3       | 31,5 | 27   | -    | -    |     |
| 2CDM 70/15                | 2CD 70/15                    | 1,1  | 35        | 450            | 8,1                  | 5,6                      | 3,3 | 44,5                       | 40,3       | 35,5 | 30   | -    | -    |     |
| 2CDM 70/20                | 2CD 70/20                    | 1,5  | 40        | 450            | 10,0                 | 7,0                      | 4,0 | 52,5                       | 48         | 42,8 | 36,5 | -    | -    |     |
| 2CDM 120/15               | 2CD 120/15                   | 1,1  | 35        | 450            | 8,3                  | 5,6                      | 3,3 | 60                         | 55,6       | 50,4 | 44   | -    | -    |     |
| 2CDM 120/20               | 2CD 120/20                   | 1,5  | 40        | 450            | 10,2                 | 7,0                      | 4,0 | -                          | 42         | 41   | 39,5 | 35   | 30   |     |
|                           |                              |      |           |                |                      |                          |     | -                          | 51,5       | 49,5 | 47,4 | 41,8 | 36,5 |     |

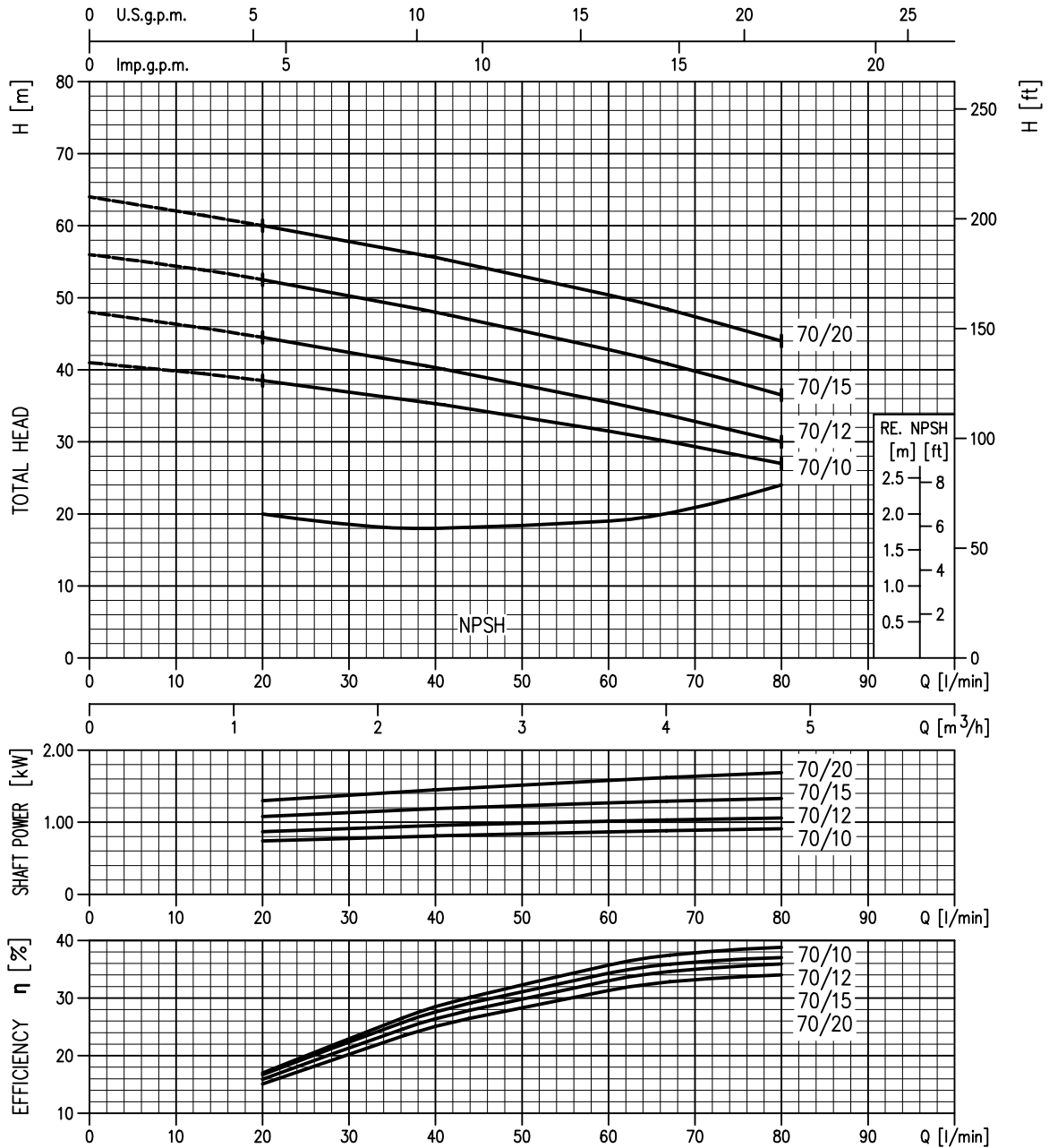
**PERFORMANCE CURVES 2CD 70 series** (according to ISO 9906 grade 2)



**PERFORMANCE CURVES 2CD 120 series** (according to ISO 9906 grade 2)

